

GN



Quick guide
Multi-Mic+

Getting to know your device

Unpacking - box contents

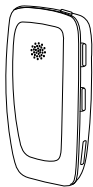

Multi-Mic+

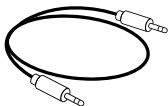

3.5mm line-in/mini-jack cable

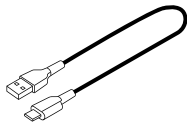

USB-A to USB-C cable
(used to supply power to the device)

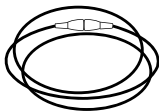

Lanyard

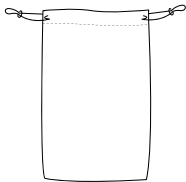

Carrying pouch

Description

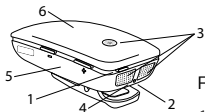

Front/top/side view

1. Power button
2. Status indicator LED
3. Microphones
4. Top
5. Side
6. Front

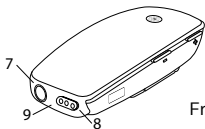

Front/bottom/side view

7. Minijack (line-in, 3.5 mm) socket
8. Socket for FM module
9. Bottom

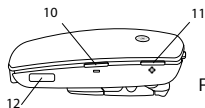

Front/side view

10. Volume decrease
11. Volume increase
12. USB-C socket

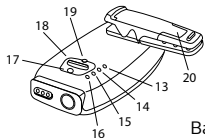

Back/bottom/side view

13. Microphone mode
14. Telecoil mode
15. Minijack (line-in, 3.5 mm) mode
16. FM (audio) mode
17. Rubber cover
18. Mode button
19. Pairing button
20. Mounting clip

How to pair hearing aids to Multi-Mic+

1. Place hearing aid(s) within two inches (five cm) of the Multi-Mic+.
2. Press pairing button on the back of the Multi-Mic+.



- The blue LED on the top will flash in short intervals while searching for a hearing aid.

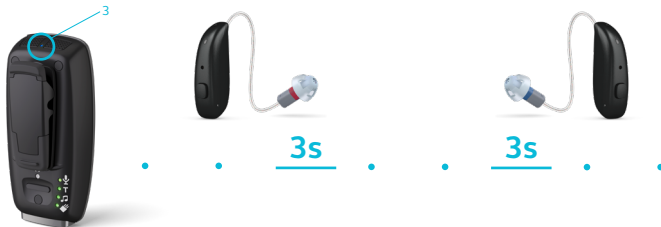

- Flashing will continue for up to 12 seconds for the first hearing aid, followed by a solid blue indicator for three seconds, and the typical hearing aid trill, when paired.
- The second hearing aid of the set will then commence pairing automatically.
- Flashing will continue for another 15 seconds as the Multi-Mic+ searches for more devices. If there are no more devices detected, searching will cease.

For more information

Refer to the user guide included in your Multi-Mic+ box. For additional support, please contact the technical support number included in your hearing aid box.

Your hearing care professional can be reached at: _____

Manufacturer according to
EU Medical Device Regulation
2017/745:

GN Hearing A/S
Lautrupbjerg 7
DK-2750 Ballerup
Denmark

Manufacturer according to FDA:

GN Hearing
8001 E Bloomington Freeway
Bloomington, MN 55420
USA



402943011

402943011 Rev A 2024.07